

Client:
 JSK Consulting Engineers

Designed JSK 14/11/17

Drawn JSK 14/11/17

Checked

Approved

| Rev | Description | By | Date |
|-----|--------------|-----|----------|
| A | Release | JSK | 12/10/17 |
| B | Note Changes | JSK | 13/02/18 |
| | | | |
| | | | |
| | | | |

All dimensions in mm

- Notes:
1. The alternative fixed and floating edges are not recommended for high earthquake areas as there is a higher chance of joint cracking around the perimeter
 2. The fasteners shown in Table 1 are the minimum required sizes
 3. This drawing is to be used in conjunction with the supporting seismic design information
 4. Plasterboard linings are to be installed to the manufacturers recommendations

Title:
 T&R Plasterboard Grid Seismic Edge Details

Project: JSK-017

Scale: NTS

DRG. No: JSK-017

Sheet: 1 of 1

Table 1: Substrate Fasteners

| Substrate Type | Fastener Type | Depth of embedment into substrate |
|----------------|--------------------------------|-----------------------------------|
| Concrete | HUS-H6 HILTI anchor | 55mm |
| Timber | 10g wood screw, length to suit | 35mm |
| Steel | 10g tek screw, length to suit | - |

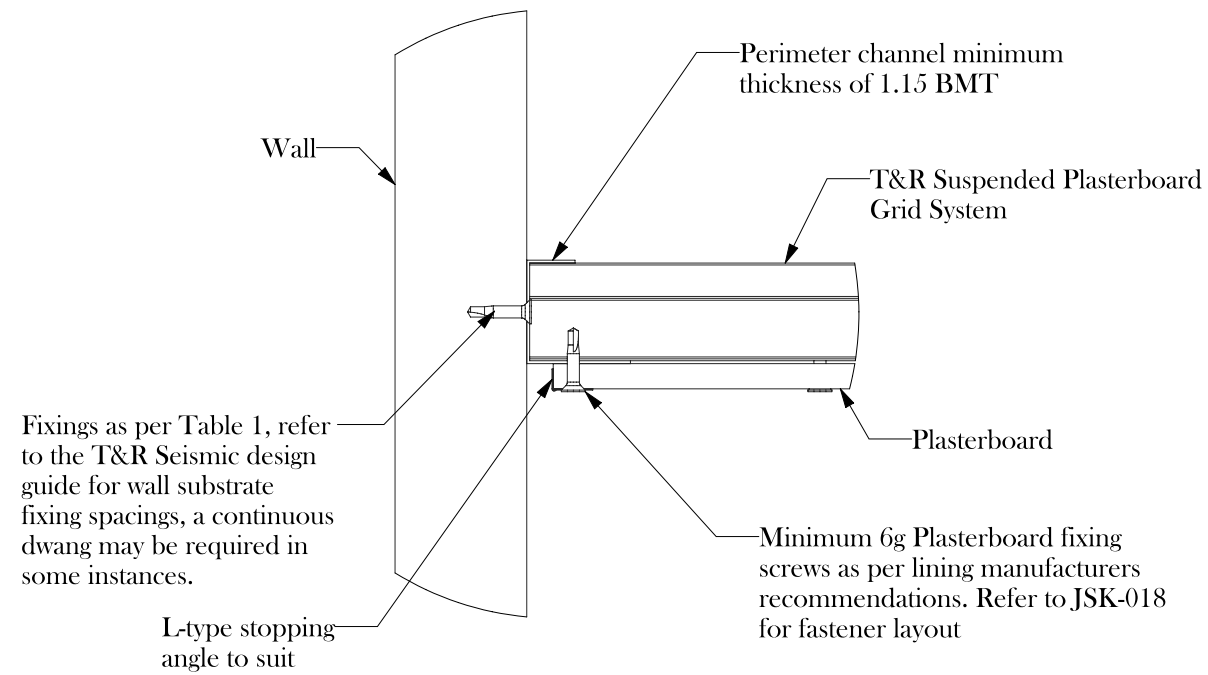

Recommended fixed edge

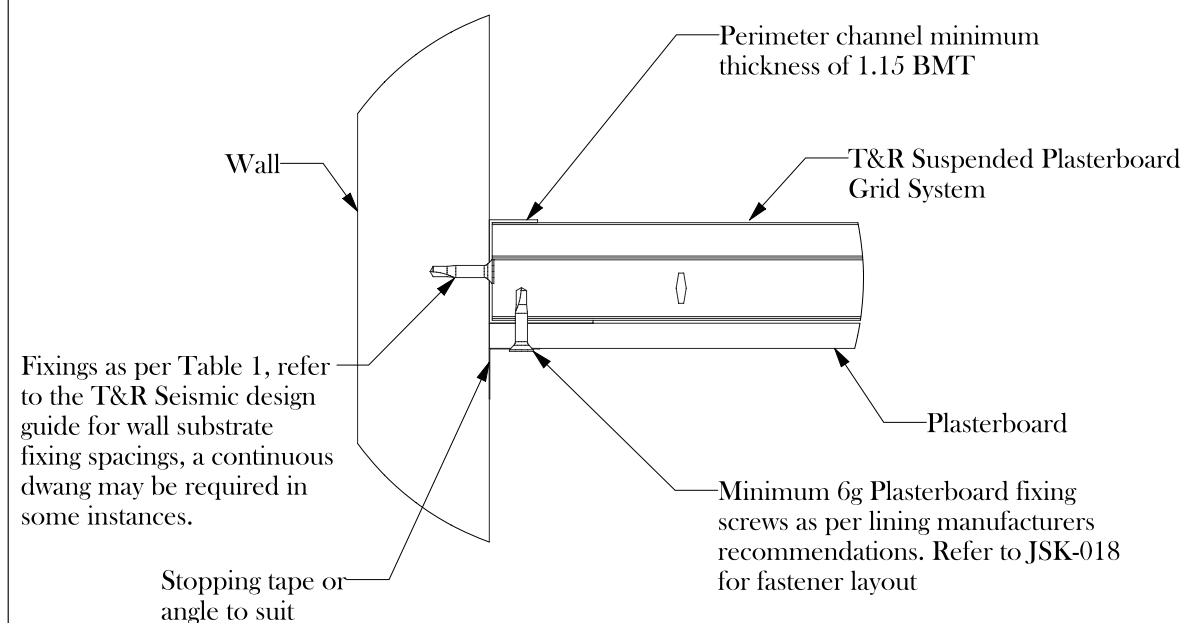

Alternative fixed edge

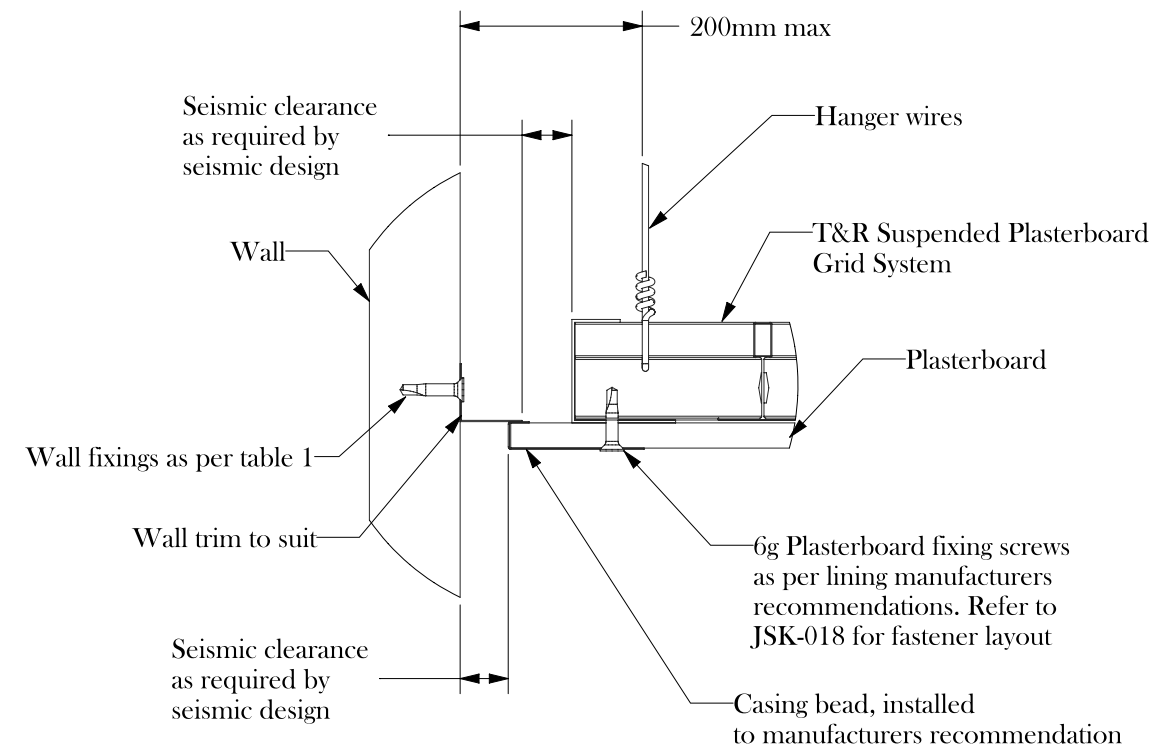

Recommended floating edge

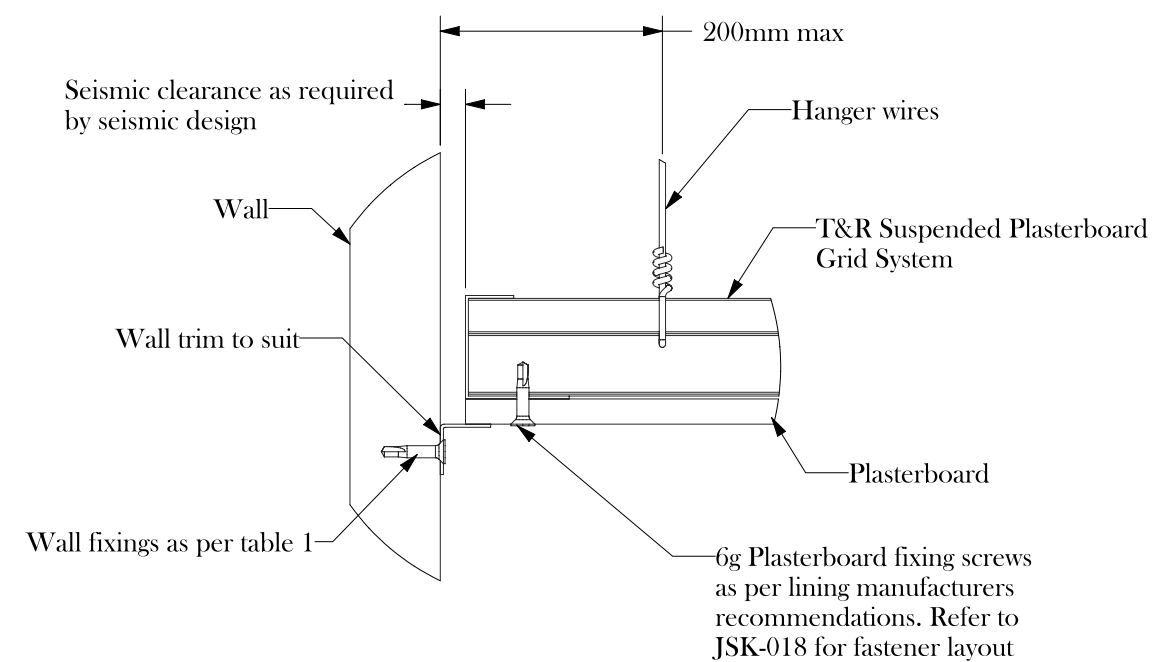

Alternative floating edge