

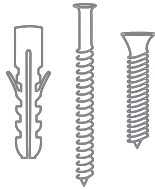

PHONIC ACOUSTIC CEILING TILES

INSTALLATION GUIDE PHONIC DIRECT FIX TILE ON CHANNEL

YOU WILL NEED



Screws

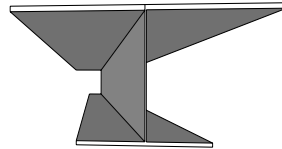

H Clip

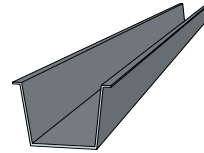

Furring Channel
Or timber batten

H-Clip - 

Furring Channel - 

C Max Direct Fix Tiles - 

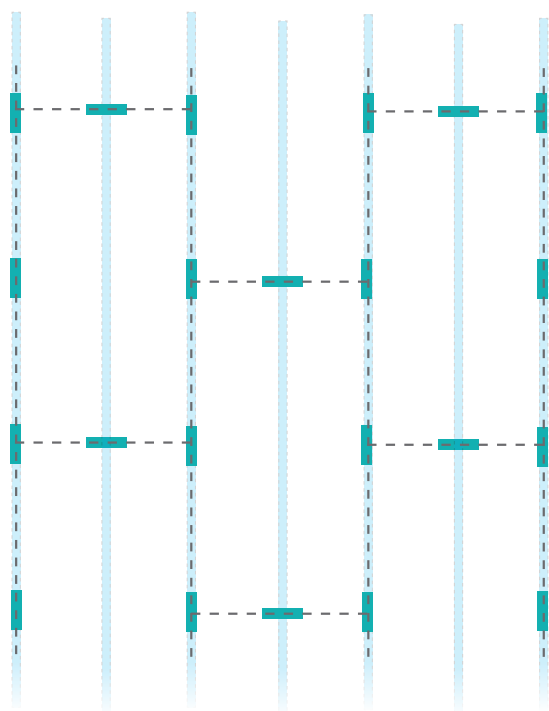

1200x600

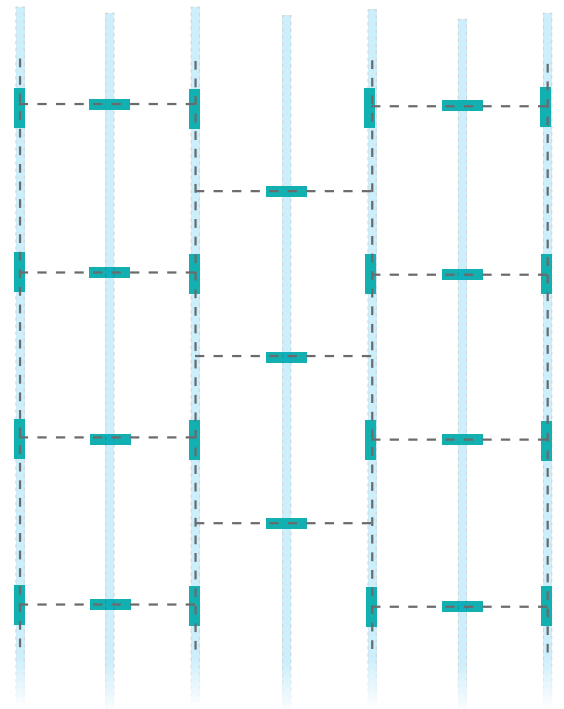

600x600

