

## Acoustic Insulation Product Data Sheet

### Application

NOVAhush acoustic insulation is made in New Zealand from 100% white lofted thermally bonded polyester fibres. NOVAhush has been designed for a wide range of acoustic treatments in building structures such as walls, partitions, ceilings and mid floor infill.

NOVAhush insulation performs as an acoustic infill material by providing sound absorption within the cavity; this reduces the sound transmission of the structure.

### Product features and benefits

- NOVAhush contains recycled polyester fibre made from plastic bottles.
- NOVAhush helps to create comfortable internal environments by improving sound insulation between spaces. Using NOVAhush will reduce sound intensity at all frequencies.
- As well as reducing noise transfer between rooms, NOVAhush also provides thermal insulation which may improve the energy efficiency of the space insulated.
- NOVAhush is safe and easy to work with. No precautions are required for handling the product. It will not cause irritation when touched, and gives off no fumes or odours.
- Manufactured in New Zealand.

\*InsulPro guarantee that, provided the insulation is installed correctly and remains adequately protected, NOVAhush, NOVAfloor and NOVAtherm will perform as well as when installed for at least 50 years.

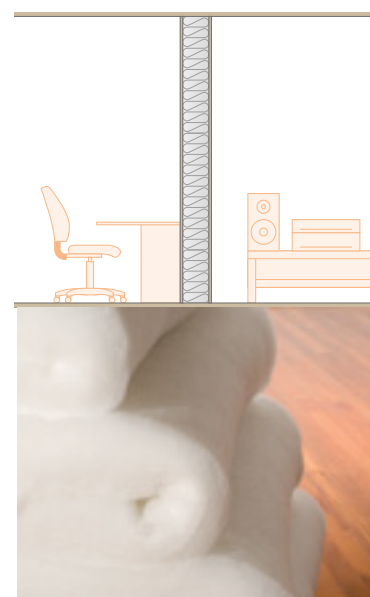

### Product range

		Bale Pack Sizes			
		Nominal Thickness (mm)	Dimensions (mm)	Rolls per pack	Total Area (m <sup>2</sup> )
NOVAhush Product Range	Product Weight (grams/m <sup>2</sup> )				
NOVAhush 580	580	60	600 x 25000	2	30
NOVAhush 750	750	60	600 x 11110	3	20
NOVAhush 900	900	90	600 x 11110	3	20
NOVAhush Sound Blanket (roll)	1,100	90	580 x 11490	3	20
NOVAhush Sound Blanket (pads)	1,100	90	580 x 11600	17	11.4

NOVAhush is available in different densities depending on the acoustic application and performance required. Contact InsulPro or your authorised distributor to discuss your requirements.

### Building System Performance

Product	Studs	Lining	Transmission Performance (STC Class / Rw)
NOVAhush 580	64mm steel	13mm plasterboard both sides	41 (Rw41)
NOVAhush 750	64mm steel		43 (Rw 42)
NOVAhush 900	92mm steel		48 (Rw 47)
NOVAhush Sound Blanket	90mm timber		TBC

Higher STC results can be achieved with different choice of studs and specialist acoustic linings.

## Technical details

Technical Attributes	Standard	Test Result
<b>Sound Absorption</b>		
Noise Reduction Coefficients (NRC)	ASTM C423	
	- 580g/m <sup>2</sup>	0.70
	- 750g/m <sup>2</sup>	0.85
	- 1,000g/m <sup>2</sup>	0.90
<b>New Zealand Building Code</b>		
Durability	Clause B2.3.1a) 15 years Clause B2.3.1b) 50 years	NOVAhush acoustic blanket has the same technical attributes as NOVATHERM
Internal Moisture	Clause E3.3.1	
Hazardous Building Materials	Clause F2.3.1	
<b>Product Safety</b>		
Non Toxic	OSH Health and Safety Guidelines <sup>1</sup>	Polyester products 'non-toxic' and 'non-irritant'
Non Irritant		
Respiratory Safe	n/a	Polyester fibres are non-respirable
Non Flammable	AS 1530 Part 3:	
	Ignitability	0 (Scale 0:20)
	Spread of Flame	0 (Scale 0:10)
	Heat Evolved	0 (Scale 0:10)
	Smoke Developed	3 (Scale 0:10)
VOC Emission Safe	Greenguard limits <sup>2</sup> Total VOC ≤ 0.5mg/m <sup>3</sup> Formaldehyde ≤ 0.06mg/m <sup>3</sup>	Level below detection Level below detection
<b>Other</b>		
Non Corrosive	AS/NZS4859.1	Materials composed entirely of polyester are regarded as non-corrosive and are exempt from testing. Polyester has alkalinity of pH7.8
Moisture Resistant <sup>3</sup>		Absorption rate of less than 0.2% by weight
Vermin Resistant	n/a	Not a food source for vermin (and not treated)
Odourless	n/a	NOVAhush is odourless and will not absorb odours

1 Occupational Health and Safety Service. Health and Safety Guidelines for the Selection and Safe Handling of Synthetic Mineral Fibres. Department of Labour, 1994, p18.

2 All individual VOCs were less than their threshold limit values. Carcinogens and reproductive toxins were not identified as part of the VOCs

3 If the product should become wet the full thermal performance will be restored once the product is dried completely

## Specification and installation

For NOVAhush specification advice contact an InsulPro representative.

NOVAhush must be installed according to the manufacturer's guidelines, which are printed on the back of each bale label. These guidelines are also available at [www.insulpro.co.nz](http://www.insulpro.co.nz) or call InsulPro on 0800 100 007.



**InsulPro**



**INT&RIOR SYSTEMS**  
creating quality ambient spaces

## Creating better environments with NOVAhush

- NOVAhush helps to create a more comfortable living environment.
- A more energy efficient space will protect the environment by consuming less fossil fuels for heating and cooling.
- All NOVAhush products contain recycled polyester fibres. The recycled fibre used by InsulPro comes from recycled plastic bottles.
- Recycling plastic protects the environment by keeping the carbon content locked up in the polyester fibre and reducing landfill waste.
- NOVAhush is made in a near zero waste production process, and is fully recyclable.

For more information go to [www.insulpro.co.nz](http://www.insulpro.co.nz) or contact an InsulPro representative.

Available from T & R Interior Systems' Warehouses:

Wellington  
Auckland  
Christchurch

/t/ 0800 666 556

/w/ [www.tr-interiorsystems.co.nz](http://www.tr-interiorsystems.co.nz)